

MATERIAL:

INDOOR RATED
SOLID BODY & COVER
CLEAR COVER

ABS/PC BLENDED PLASTIC
UL94-5VB FLAMMABILITY RATING
-40°C TO +70°C TEMPERATURE RANGE
POLYCARBONATE PLASTIC
UL94-VO FLAMMABILITY RATING
-40°C TO +70°C TEMPERATURE RANGE
UV STABILIZED

OUTDOOR RATED
SOLID BODY & COVER

PBT/PC BLENDED PLASTIC
UL94-5VA FLAMMABILITY RATING
-40°C TO +70°C TEMPERATURE RANGE
UV STABILIZED

FINISH:

BODY
COVER

LIGHT GRAY
LIGHT GRAY OR CLEAR

COVER IS GASKETED.

AIR AND MOISTURE VENTS, STAINLESS
STEEL LOCKING HASP, PANEL MOUNTING
RAILS, GALVANIZED STEEL INNER PANEL
AND STAINLESS STEEL WALL MOUNTING
BRACKETS ARE NOT INCLUDED, BUT CAN
BE PURCHASED SEPARATELY.

INDUSTRY STANDARDS:

INDOOR RATED
UL508 TYPE 1, 2, 4, 4X INDOOR, 12 & 13
NEMA TYPE 1, 2, 4, 4X, 12 & 13
IEC529, IP66
OUTDOOR RATED
UL508 TYPE 1, 2, 4, 4X, 12 & 13
NEMA TYPE 1, 2, 4, 4X, 12 & 13
IEC529, IP66

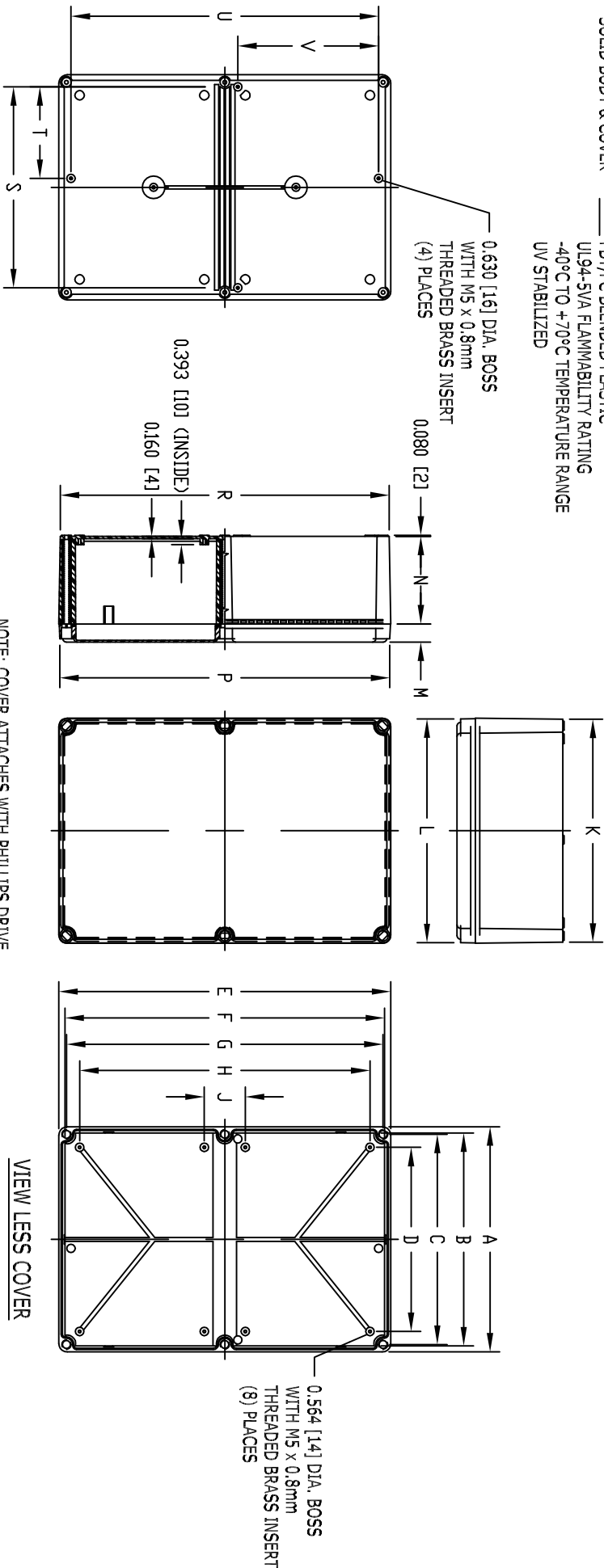

DIMENSIONS = INCHES
[MILLIMETERS]

NOTE: COVER ATTACHES WITH PHILLIPS DRIVE
NON-METALLIC SCREWS. (NOT SHOWN)

NOTE: ALL DIMENSIONS HAVE ± 0.039 [± 1] TOLERANCE
UNLESS OTHERWISE SPECIFIED

INDOOR RATED	OUTDOOR RATED
PART NO.	PART NO.
SOLID COVER	CLEAR COVER
NBD-10456	NBD-10476
CLEAR COVER	SOLID COVER
NBD-10476	NBD-15456

DIMENSIONS																		
A	B	C	D	E	F	G	H	J	K	L	M	N	P	R	S	T	U	V
14.975	14.170	13.984	12.252	22.085	21.260	21.062	19.313	2.724	14.838	14.890	1.210	5.825	21.958	21.870	13.378	6.093	20.455	9.360
[380]	[360]	[355]	[311]	[561]	[540]	[535]	[491]	[69]	[377]	[378]	[31]	[148]	[558]	[555]	[340]	[155]	[520]	[238]

REV	DATE	DESCRIPTION	BY

Components, Inc.

SED10456-10476-15456

ENCLOSURE LAYOUT

www.jit-components.com

TOLERANCES UNLESS OTHERWISE SPECIFIED

2 PLACE DECIMALS (IN)

3 PLACE DECIMALS (IN)

ANGLES

METRIC (MM)

$\pm .02$

$\pm .005$

$\pm .5^\circ$

$\pm .15$

DESIGNER

JRK

SHEET

1 OF 1

DATE

11/14/00

SCALE

MATERIAL

REV