

SHORT SIDE PCB  
(long side to long side)  
to use with top print

4999000470

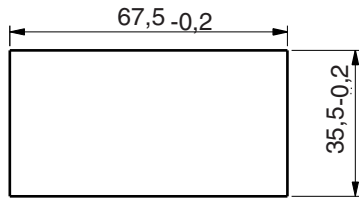

LONG SIDE PCB  
(long side to long side)  
to use when no top print

4999000570

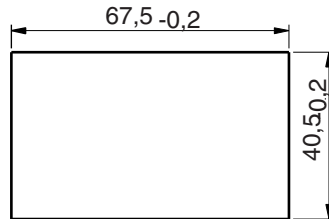

TOP PCB

4999000370

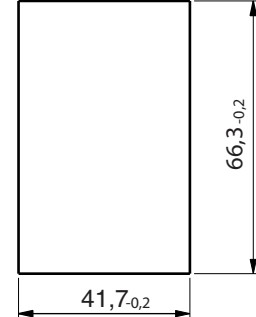

MIDDLE PCB

4999000270

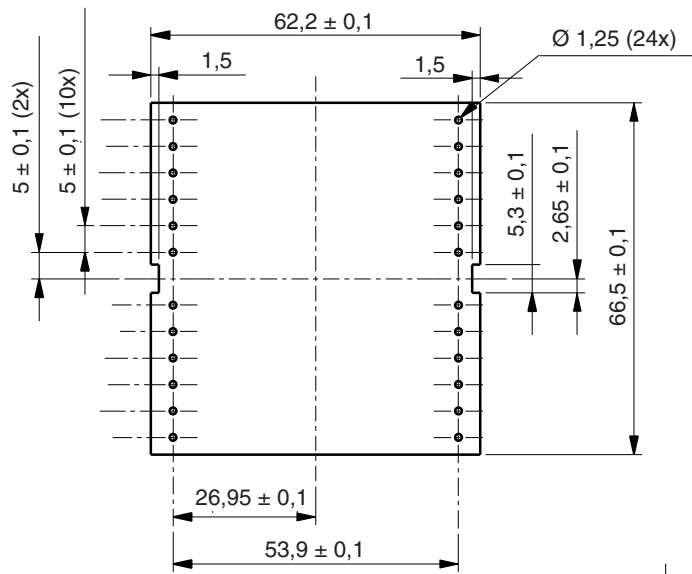
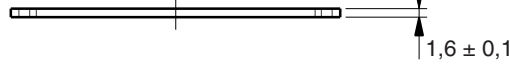

BASE PCB

4999000170

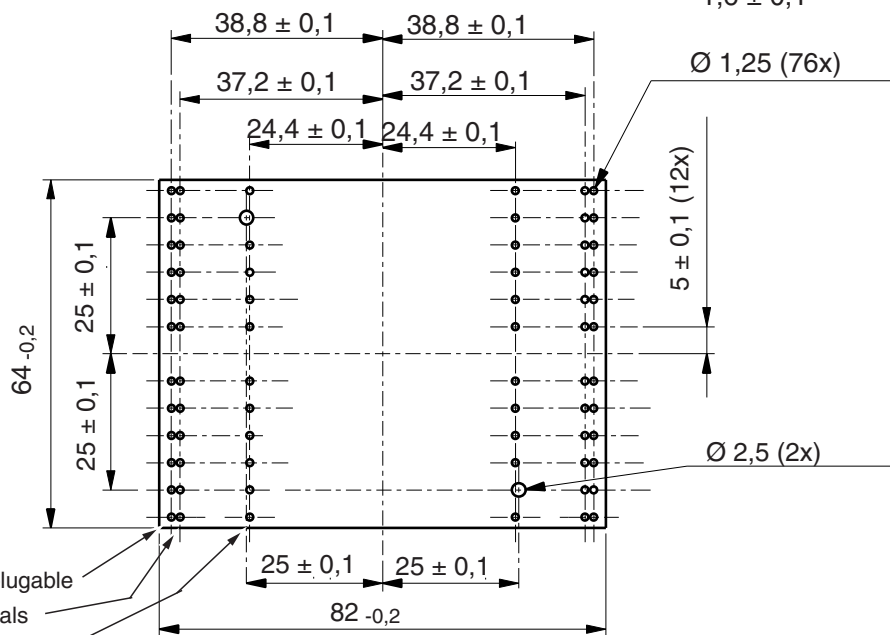

for horizontal plugable  
for fixed terminals  
for vertical plugable