



JIT Components, Inc

10930 Endeavour Way, Unit A Seminole, FL 33777

Phone: (727)544-9050 Fax: (727)544-9273

Email: service@jit-components.com

JIT Series JLP

- Textured finish.
- Molded in flame retardant ABS.
- Flammability:
 JLP11, 21, 31, 41, 51 & 61 have UL95-5VA
 JLP35, 55 & 70 have UL94-V0
 All recessed cover option have UL94 V0
- Colors: Black, Gray, PC Bone.
- Available with or without PCB mounting bosses.
- Flush, textured or recessed, smooth covers.
- Available with or without mounting feet.
- Custom perforating and printing also available.

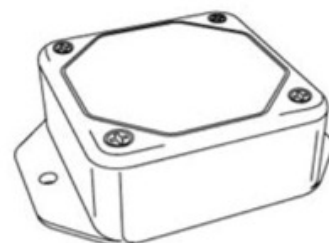
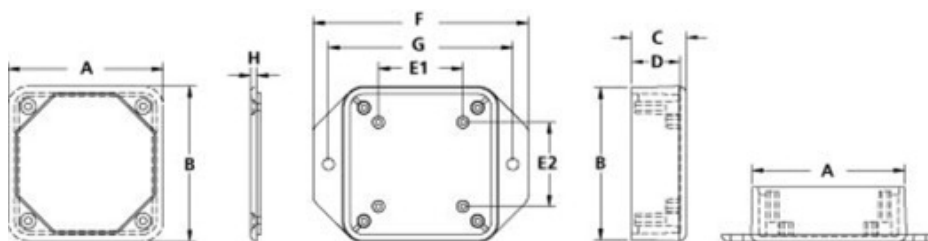

Catalog Number	Length A	Width B	Height C	Inside Depth D	PCB Bosses		Mtg. Boss Height	Mtg. Feet Length F	Mtg. Feet Holes G	Cover Thickness H
					E1	E2				
JLP-11P	2.500	2.500	0.900	0.800	1.375	1.375	0.230			0.100
JLP-11F	2.500	2.500	0.900	0.800	1.375	1.375	0.230	3.500	3.000	0.100
JLP-21P	3.290	2.420	1.000	0.900	2.125	1.250	0.230			0.100
JLP-21F	3.290	2.425	1.000	0.900	2.125	1.250	0.230	4.375	3.875	0.100
JLP-31P	4.165	2.800	1.000	0.900	3.000	1.625	0.230			0.100
JLP-31F	4.165	2.800	1.000	0.900	3.000	1.625	0.230	5.125	4.625	0.100
JLP-35	4.250	3.000	1.375	1.305	3.160	1.910	0.250			0.070
JLP-35F	4.250	3.000	1.375	1.305	3.160	1.910	0.250	5.250	4.750	0.070
JLP-41P	3.300	3.300	1.250	1.150	2.125	2.125	0.230			0.100
JLP-41F	3.300	3.300	1.250	1.150	2.125	2.125	0.230	4.250	3.750	0.100
JLP-51P	4.550	3.300	1.250	1.150	3.375	2.125	0.230			0.100
JLP-51F	4.550	3.300	1.250	1.150	3.375	2.125	0.230	5.500	5.000	0.100
JLP-55	5.000	3.500	1.500	1.430	3.910	2.410	0.250			0.070
JLP-55F	5.000	3.500	1.500	1.430	3.910	2.410	0.250	6.000	5.500	0.070
JLP-61P	5.560	3.800	1.250	1.150	4.375	2.625	0.230			0.100
JLP-61F	5.560	3.800	1.250	1.150	4.375	2.625	0.230	6.500	6.000	0.100
JLP-70	5.500	4.250	1.750	1.660	4.125	2.875	0.230			0.080
JLP-70F	5.500	4.250	1.750	1.660	4.125	2.875	0.230	6.600	6.090	0.080